

ACTIVE[®]

MADE IN ITALY



Accessories catalogue
2026



Professional accessories

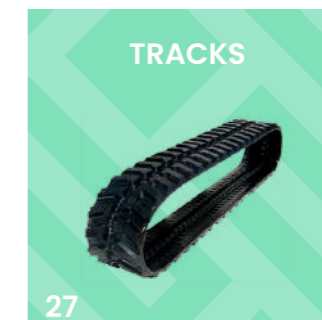

Tap&Go Heads

120 FAST

With simplified line insertion.

130 SAFE

The fastest line loading system in its category, featuring a robust spool.

120

The smallest and lightest in the range.

150 PRO

The largest in the series, featuring two cutting levels (mulching effect).

130 LIGHT

The fastest line loading system in its category, with a lightweight spool.



Save time and effort with ACTIVE heads

Tap&Go System:

a feature that allows the line to extend without interrupting work to do it manually. Simply tap the ground with the brushcutter at high speed, and the rotating head will automatically release the line, allowing continuous cutting without pauses.

SIGNIFICANT TIME SAVINGS

Easy line reloading system:

ACTIVE was the first company to design a Tap&Go head with simplified reloading. Unlike traditional heads, where the line must be manually inserted and wound into the spool, ACTIVE's 120 and 150 heads allow for a quicker and more intuitive process.

Thanks to a convenient guide tube, the line can be easily inserted into the head and, by simply turning the knob, it winds automatically into the spool.

In the 120 RAPIDO and 130 models, the guide tube is not necessary: just insert the line through the cable eyelets and turn the knob for automatic winding.

INVALUABLE EFFORT SAVINGS

Line reloading system

** In models 150 and 120, the line is inserted via the guide tube*

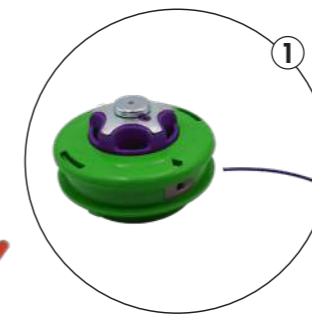

Align the arrow with the eyelet and insert the line*



Even the line lengths

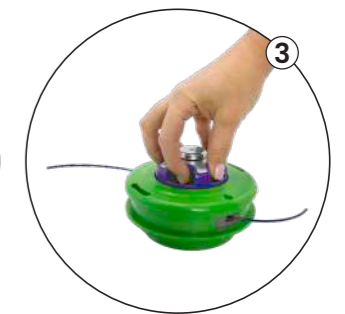

Press and rotate the knob to wind the line

Convenient opening system:

The practical head opening system allows the cover to be easily detached from the main body. By simultaneously pressing the knob and the two tabs located on the lower part of the head, the cover can be quickly released, providing easy access for maintenance operations or for

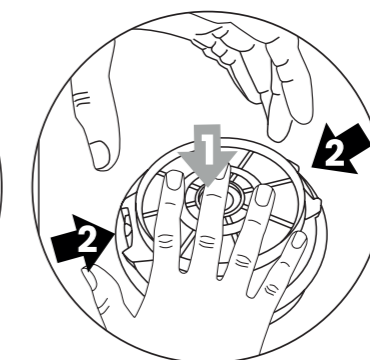
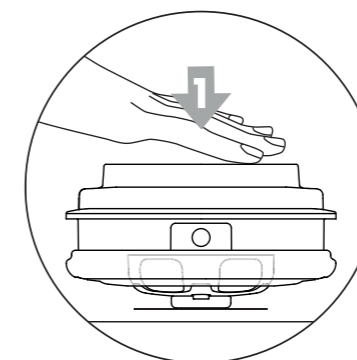



new

130



Ultra-fast line insertion system

Thick cover for greater durability

Bushings securely fixed to the head body

SAFE VERSION
reinforced spool with wear-resistant steel knob

LIGHT VERSION
suitable for low-displacement brushcutters

Spring designed for optimal force distribution

Spool made of special nylon



Line loading capacity
Some examples

Line size (mm)	2.4	2.7	3.0	3.3	3.5	4.0	3.0	3.5	3.3
Line cross-section	Tondo						Quadro		Sega
Head capacity (m)	12.0	9.0	7.8	6.8	5.5	3.5	5.2	4.5	3.0

130 Head

Safe Version

Spool with wear-resistant steel protection



Pack of 20 pcs

Code	Model
028150	M8 x 1.25 SX - M
028151	M8 x 1.25 SX - F
028152	M10 x 1.0 SX - F
028153	M10 x 1.25 SX - F
028154	Universal
028155	Without Insert

Light Version

Lightweight plastic spool



Pack of 20 pcs

Code	Model
028157	Universal
028156	Without Insert

AB Seats for the insert to fix the head to the brushcutter

C Precast aluminum line guide bushings, wear-resistant

D Line guide insert allowing line loading without the use of additional tools

E Cover equipped with clips for quick opening

F Spool with high line storage capacity

G Calibrated spring to prevent accidental or unintentional line unwinding

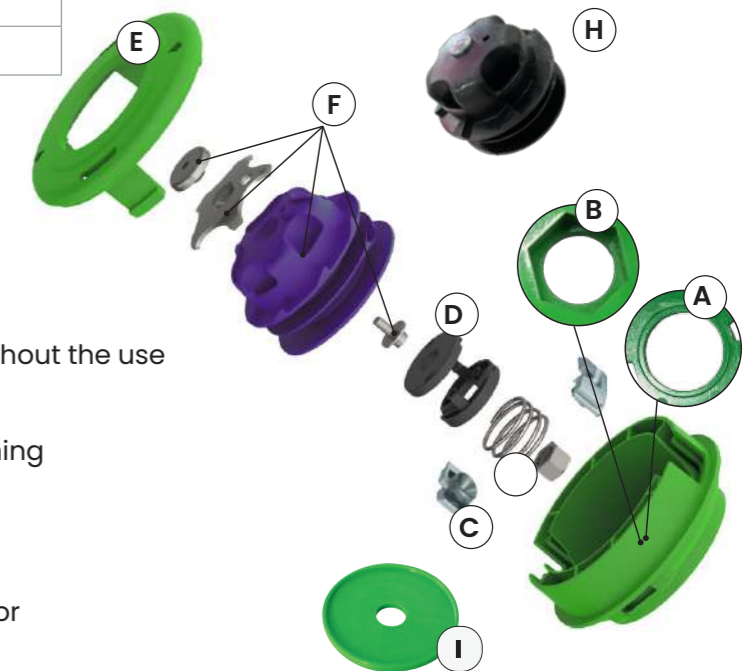

Code	Description
026482	Universal head body (A)
026481	Head body with insert (B)
025502	Line guide bushing (C)
025503	Internal line guide insert (D)
026479	Cover (E)
027068	Safe spool (F)

Code	Description
027843	Light spool (H)
021008	Spring (G)
021548	Adapter for bevel gears with long shaft (I)
021006	Universal washer Ø10
021078	Universal washer Ø12
021076	Spacer (25.4-20)

150 PRO

WITH LINE GUIDE TUBE



Two cutting levels

Shredded grass with mulching effect

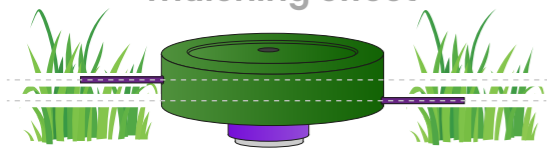

Line loading capacity

Some examples

Line size (mm)	2.4	3.0
Line cross-section	Tondo	
Head capacity (m)	16.5	10.0



Single pack

Code	Model
022200	M7 x 1 SX - M
022201	M8 x 1.25 SX - M
022202	M8 x 1.25 SX - F
022203	M10 x 1 SX - F
022204	M10 x 1.25 SX - M
022205	M10 x 1.25 SX - F
022206	M10 x 1.5 SX - M
022207	M10 x 1.5 SX - F
022224	M12 x 1.25 SX - F
022209	M12 x 1.5 SX - F
022210	M12 x 1.75 SX - F
022416	M14 x 1.5 SX - F
022212	Universal
022213	Without Insert

150 PRO Spare Parts

Code	Description
022197	Cover (A)
021537	Knob (B)
021538	Spool (C)
020362	Spring (D)
022199	Body for insert (E)
022198	Body for universal insert (E)
020358	Large aluminum bushing (F)
020357	Small aluminum bushing (G)
020363	Line guide tube (H)
021548	Adapter for bevel gears with long shaft (I)
020681	Universal washer Ø10
021076	Spacer (25.4 - 20)

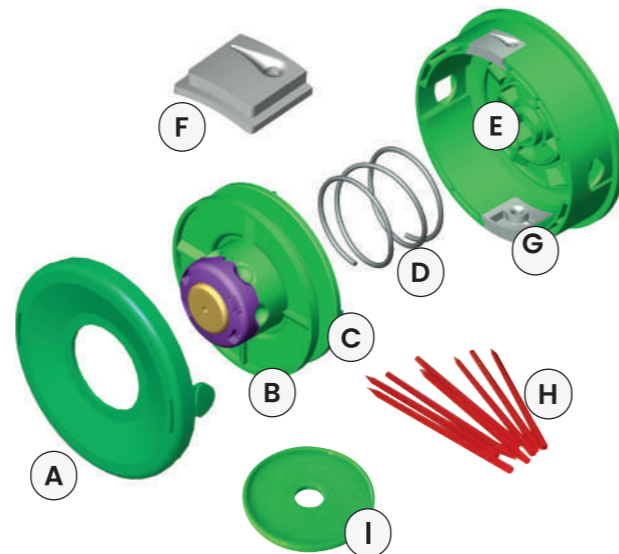

120

WITH LINE GUIDE TUBE



Plastic knob

Pack of 20 pcs



Steel knob

Pack of 20 pcs



Code	Model
023115	M8 x 1.25 SX - M
023116	M8 x 1.25 SX - F
023117	M10 x 1.0 SX - F
023119	M10 x 1.25 SX - F
023120	M10 x 1.5 SX - M
023121	M10 x 1.5 SX - F
023122	M12 x 1.25 SX - F
023125	M14 x 1.5 SX - F
023126	Universal
023127	Without Insert

Code	Model
023129	M8 x 1.25 SX - M
023130	M8 x 1.25 SX - F
023131	M10 x 1.0 SX - F
023133	M10 x 1.25 SX - F
023134	M10 x 1.5 SX - M
023135	M10 x 1.5 SX - F
023139	M14 x 1.5 SX - F
023140	Universal
023141	Without Insert

120 Spare Parts

Code	Model
021004	Cover (A)
021995	Steel knob spool (B)
021005	Nylon knob spool (C)
021008	Spring (D)
021003	Body for insert (E)
021007	Body for universal insert (E)
021002	Brass bushing (F)
021241	Oversized bushing for saw line (F)
020363	Line guide tube (H)
021548	Adapter for bevel gears with long shaft (I)
021006	Universal washer Ø10
021078	Universal washer Ø12
021076	Spacer (25.4-20)

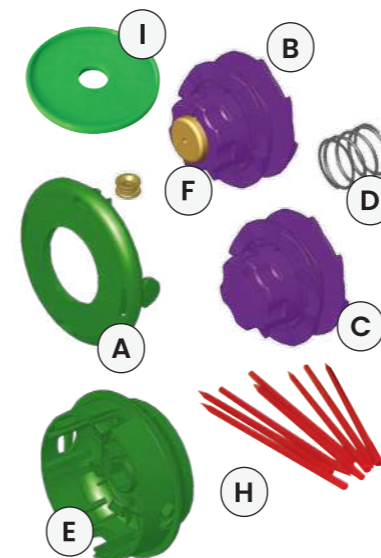

120 FAST



Plastic knob



Pack of 20 pcs

Steel knob



Pack of 20 pcs

Code	Model
023142	M8 x 1.25 SX - F
023143	M10 x 1.25 SX - F
023144	Universal
023145	Without Insert

Code	Model
023146	M8 x 1.25 SX - F
023147	M10 x 1.25 SX - F
023148	Universal
023149	Without Insert

Spare Parts 120 FAST

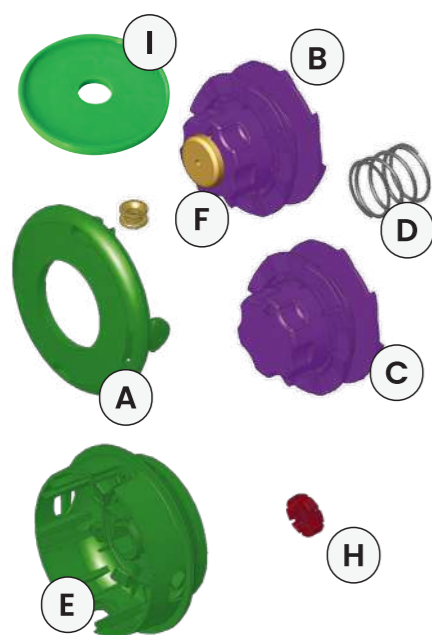

Code	Model
021004	Cover (A)
025389	Steel knob spool (B)
025388	Nylon knob spool (C)
021008	Spring (D)
022579	Housing for insert (E)
022580	Universal insert housing (E)
021002	Brass bushing (F)
021241	Oversized bushing for saw line
022578	Line guide (H)
021548	Adapter for bevel gears with long shaft (I)
021006	Universal washer Ø10
021078	Universal washer Ø12
021076	Spacer (25.4-20)

Line loading capacity

Some examples

Line size (mm)	2.4	3.0
Line section	Round	
Head capacity (m)	10.0	7.0

Head inserts



Code	Description
020379	Insert M10x1.5-M
020469	Insert M10x1.5-F
020632	Insert M12x1.25-F
020384	Insert M12x1.5-F
020378	Insert M12x1.75-F
020500	Insert M14x1.5-F

Code	Description
020376	Insert M7x1.0-M
020380	Insert M8x1.25-M
020381	Insert M8x1.25-F
020377	Insert M10x1.0-F
020382	Insert M10x1.25-M
020383	Insert M10x1.25-F



PLATINO®

Registered trademark since 2003



PLATINO®

Durable nylon line resistant up to 180°C



PLATINO®

300°C resistant

Durable nylon line resistant up to 300°C



PLATINO®

ecosilent

Silent nylon line that minimizes consumption



Available in 4 formats



Wear Test



Research Results

The performance of ACTIVE's 3.3 mm PLATINO® nylon line (E) in the wear test was far superior to that of other well-known nylon line brands (A, B, C, D)

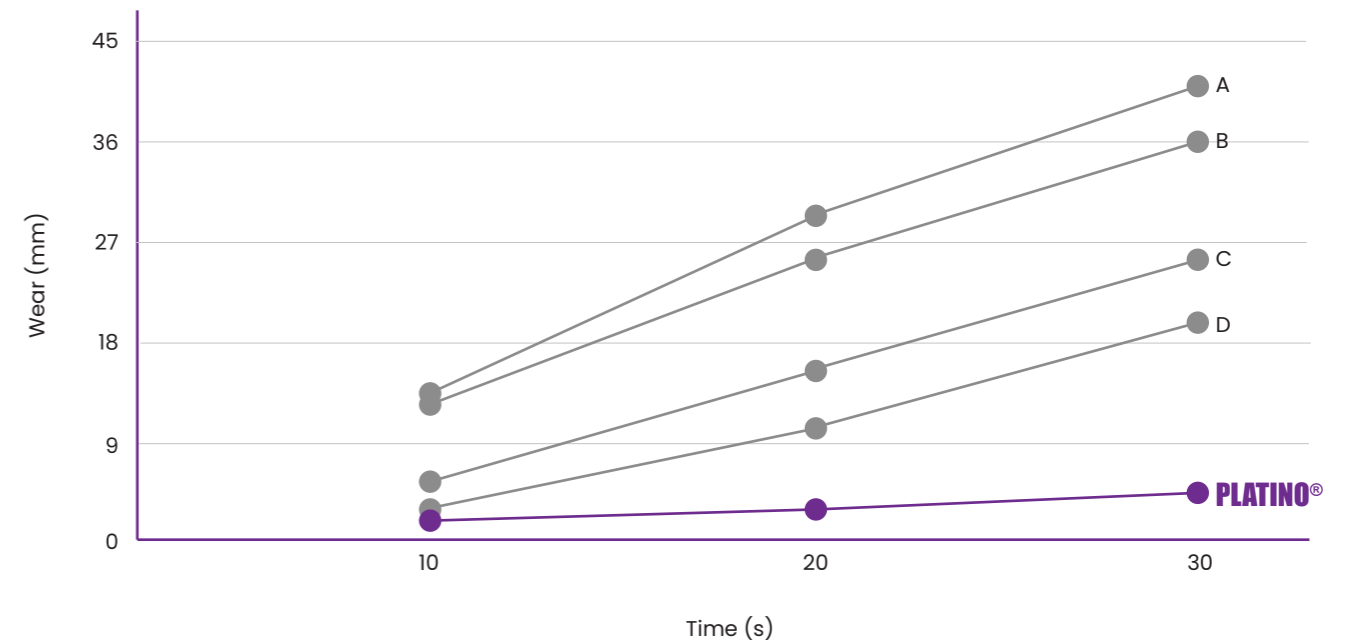

Cumulative Wear

10 s interval – 30 mm interference

For 3.3 mm lines, wear was generally lower compared to 2.4 mm lines.

NEW FOR 2026

PLATINO® STAR SECTION





6-ribbed star-shaped line = 6 benefits

- More aggressive cutting:** the star shape has sharp edges that act like blades, cutting grass and small shrubs more cleanly and effectively.
- Better performance on dense vegetation:** ideal for tall grass, tough weeds, or harder vegetation, where a round line may struggle.
- Cleaner cut:** the edges produce a more defined cut, reducing grass shredding and helping to maintain a neater lawn appearance.
- Less overheating:** thanks to its irregular section, the star-shaped line dissipates heat better than the round one, extending its life during heavy use.
- Lower air resistance:** the shape reduces turbulence, decreasing movement resistance.
- Reduced aerodynamic drag = lower fuel consumption**

LINE CONVERSION TABLE				
	ROUND	SQUARE	SAW	STAR
Ø mm	mt./kg.	mt./kg.	mt./kg.	mt./kg.
1.3	680	-	-	-
1.6	470	-	-	-
2.0	270	-	-	-
2.4	200	175	-	-
2.7	150	135	134	-
3.0	134	112	-	142
3.3	112	90	90	118
3.5	92	-	-	94
4.0	74	60	60	-
5.0	45	-	-	-
6.0	30	-	-	-

 **ROUND Section**
da 1.3 a 6.0 mm

 **SQUARE Section**
da 2.4 a 4.0 mm

 **SAW Section**
da 2.7 a 4.0 mm

 **STAR Section**
da 3.0 a 3.5 mm

Possible deviation from actual values in mt./kg = +/- 5%



ACTIVE's technology and experience have led to the creation of the PLATINO® nylon line, a product that, thanks to its **exceptional resistance and durability features**, stands out as truly unique and unmatched on the market.

Packs of 20 pcs

	15 m	0,5 Kg
Thickness	Code	Code
1.3 mm	020957	-
1.6 mm	020958	020996
2.0 mm	020702	-
2.4 mm	023153	023170
2.7 mm	023154	023171
3.0 mm	023155	023172
3.3 mm	023156	023173
3.5 mm	023157	023174
4.0 mm	023158	023175

	15 m	0,5 Kg
Thickness	Code	Code
2.4 mm	023159	023176
2.7 mm	023160	023177
3.0 mm	023161	023178
3.3 mm	023162	023179
4.0 mm	023163	023180





⁽¹⁾Sold as a single unit.

	15 m	0,5 Kg
Thickness	Code	Code
2.7 mm	023164	023181
3.3 mm	023165	023182
4.0 mm	023166	023183

	15 m	0,5 Kg
Thickness	Code	Code
3.0 mm	028172	028175
3.3 mm	028173	028176
3.5 mm	028174	028177

Single package

	2 Kg	~ 8 Kg Price per Kg
Thickness	Code	Code
1.3 mm	020949	020977
1.6 mm	020979	020978
2.0 mm	020557	020969
2.4 mm	020529	020970
2.7 mm	021020	021021
3.0 mm	020507	020971
3.3 mm	020509	020972
3.5 mm	020534	020973
4.0 mm	020698	020974
5.0 mm	- new	027956
6.0 mm	- new	027957

	2 Kg	~ 8 Kg Price per Kg
Thickness	Code	Code
2.4 mm	020533	020975
2.7 mm	020512	020513
3.0 mm	020532	020976
3.3 mm	021046	021047
4.0 mm	020312	020319



	2 Kg	~ 8 Kg Price per Kg
Thickness	Code	Code
2.7 mm	021566	021569
3.3 mm	021567	021570
4.0 mm	021568	021571

	~ 8 Kg Price per Kg
Thickness	Code
3.0 mm	027944
3.3 mm	027945
3.5 mm	027946



PLATINO® Special lines

PLATINO® T300 **300°C resistant**

LINE CONVERSION TABLE	
Round Section	
Ø mm	mt./kg.
3.0	138
3.3	122
4.0	76



Possible deviation from actual values in mt./kg = +/- 5%



Equipped with an additional outer sheath, it prevents sticking by resisting temperatures up to 300°C.

The extra sheath also ensures exceptional durability and greater abrasion resistance—features unmatched on the market.

The line for professionals who never settle!

Packs of 20 pcs



Thickness	Code	Code
2.5 mm	023184	023187
3.0 mm	023185	023188
3.5 mm	023186	023189

Single package



Thickness	Code	Code
2.5 mm	021706	021709
3.0 mm	021707	021710
3.5 mm	021708	021711

PLATINO® **ecosilent**

LINE CONVERSION TABLE	
Helical Section	
Ø mm	mt./kg.
3.0	138
3.3	122
4.0	76



Possible deviation from actual values in mt./kg = +/- 5%



Line with PLATINO® quality. The special helical section generates turbulence during rotation, **minimizing air friction and ensuring quieter operation and lower fuel consumption.**

Packs of 20 pcs



Thickness	Code	Code
3.0 mm	023190	023193
3.3 mm	023191	023194
4.0 mm	023192	023195

Single package



Thickness	Code	Code
3.0 mm	022870	022873
3.3 mm	022871	022874
4.0 mm	022872	022875

Lubricants

Mixing Oil

API TC + Jaso FD

Next-generation 2-stroke engine oil developed to meet the needs of unleaded fuels. Thanks to cutting-edge formulations and the use of premium raw materials, ACTIVE oil ensures **long engine life and reliable performance**. Its properties also allow the fuel mix to remain stable for **up to 12 months**.

100% SYNTHETIC

1: 50 (2,0%)

MID-ADDITIVATED

1: 50 (2,0%)



	100 ml 30 pcs	1 L 12 pcs	5 L 4 pcs
100% SYNTHETIC	023312	022832	023313
MID ADDITIVATED	023314	022833	023315

The use of **100% synthetic Active oil** is strongly recommended for Strato Charged brushcutters, especially for high-displacement engines and demanding professional applications.

Chain Oil

100% vegetable-based oil for bar/chain lubrication. Produced exclusively from **virgin oils**, this lubricant guarantees complete biodegradability. The additives provide excellent anti-wear properties and maximum adhesion, protecting the oil pump while delivering effective **antioxidant and anti-corrosion performance**.

ACTIVE oil also offers outstanding heat resistance, a high viscosity index, and a low polymerization rate.

2 L 12 pcs	5 L 4 pcs
023310	023311



Grease for Bevel Gears

High-quality Molybdenum Disulfide grease, anti-wear and resistant to high temperatures. Due to its characteristics, it is suitable for heavy-duty applications.

90 ml bottle

Code	Number of pieces per pack
022638	20



Spray Grease, Multigrease

Top-quality, anti-wear product. Red nozzle: designed to direct the product precisely without waste. Gray nozzle: helps you easily apply grease inside ball-type grease fittings.

Spray da 200 ml

Code	Number of pieces per pack
024836	12

Coaxial Coupling Threadlocker

50 ml bottle

Code
021218



Threadlocker

50 ml bottle

Sealing	Code
Medium	020525
Strong	020311

Always using original Active lubricants ensures you get the best performance from your product. The engine oils have been tested under various working conditions to guarantee a cleaner and more reliable engine.

Only Active lubricants are optimized for Active products, allowing the engine to perform perfectly for years. The vegetable chain oil is additive-enhanced to prevent thickening at low temperatures and contains no re-refined oils.



Protective Equipment

GUARDS

Mini guard



Code
021360

Maxi guard



Code
020548

HARNESSES

Olivator



Code
021220

Ergonomic single-shoulder harness dedicated to motorized olive shakers

Easy



Code
020187

Basic single-shoulder harness with quick-release

Safe



Code
020167

Double-shoulder ergonomic harness with automatic release

VISORS

Polycarbonate visor



Code	N° of pcs
023198	10

Metal mesh visor



Code	N° of pcs
023199	10

Mesh visor with shield



Code	N° of pcs
023200	10



Protective Clothing

High-visibility
bib overalls



Code
027958



Brushes

Single package
Small steel brush



Code	Disc Ø
026458	6"

Large steel brush



Code	Disc Ø
026459	8"

Nylon brush



Code	Disc Ø
026460	8"

Prices excluding VAT



Classic series

Single package

Model	Code	Disc Ø mm	Bore Ø mm	Blade thickness (mm)	
Steel blades with double edge, 2–3–4 cutting teeth, preferably used on wide areas covered with tough or dry grass. If they hit hard obstacles, they can cause strong kickback to the brushcutter.					
	2-Tooth	020392	255	25.4	1.6
		023482	350	25.4	2.5
		020445	300	25.4	1.8
	2-Tooth	020526	300	25.4	3.0
	3-Tooth	020449	255	25.4	3.0
		020396	300	25.4	3.0
		020446	350	25.4	4.0
	3-Tooth	020450	300	20	3.0
		020451	350	20	4.0
		020118	255	25.4	1.4
	4-Tooth	020201	255	25.4	1.4
Shredder blade with 2 curved teeth in special steel, ideal for thinning and removing tough, matted grass and general brush. Not recommended for cutting vegetation with a diameter greater than 1 cm, as the long cutting edge may cause sudden impact and resulting kickback.					
	2 Curved Teeth	020115	300	25.4	3.0
Blade with 8 cutting teeth, suitable for cutting brush or weeds with thick stems (up to 0.5 cm). The small teeth reduce kickback when hitting harder objects. These blades are therefore better suited for cutting on smaller, uneven surfaces or areas with tough grass.					
	8-Tooth	020202	255	25.4	1.4
Suitable for medium- to high-displacement brushcutters, designed for cutting bushes with woody branches, knots, or young trees with a diameter under 1.5 cm. Built to gradually penetrate wood, reducing the risk of dangerous kickback. Ideal for ground-level cutting in undergrowth or natural parks.					
	20-Tooth	020524	250	25.4	2.0
	22-Tooth	020112	200	25.4	1.6

Heavy Duty Series – Made in Germany

Single package

Model	Code	Disc Ø mm	Bore Ø mm	Blade thickness (mm)	
Steel blades with double edge, 2–3 cutting teeth, preferably used on wide areas covered with particularly tough or dry grass. If they encounter hard obstacles, they cause strong kickback to the brushcutter.					
	2-Tooth	027919	255	25.4	1.6
	3-Tooth	027920	300	25.4	3.0
Made of special steel, ideal for thinning and removing tough, matted grass and general brush. Not recommended for cutting vegetation with a diameter greater than 1 cm, as the long cutting edge may cause sudden impact and resulting kickback.					
	2 Curved Teeth	027921	300	25.4	3.0

Reciprocator NEW

Alternating blade movement



Code	Model
027430	230 mm tool only
620060	230 mm tool with shaft

Compatible only with Active brushcutters



Discover all the applications of the Active reciprocator

Spark Plugs and tachometers



Model	Pack of 20 pcs	Pack of 100 pcs
AX 70	023307	027788
RX 90	023308	027790
RX 80	023316	027789
MR 80	023901	027787

Active spark plug comparison

ACTIVE	NGK	CHAMPION	BOSH	Hex and Thread
AX 70	BPM6A	CJ7Y	WKA175T6 (WS7F)	19 – SHORT
RX 90	BR2LM	RJ19LM	WR11E0	21 – SHORT
RX 80	BMR6A	RCJ8	ND	19 – SHORT
MR 80	CMR5H	ND	ND	16 – STANDARD

Digital Tachometer

Multifunction tachometer for 2-stroke and 4-stroke single-cylinder engines.

Tolerance ±10 RPM

Battery life approx. 20,000 hours

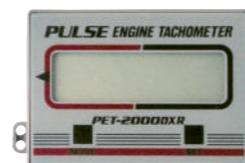

Code
020887

Rubber Tracks



Single piece

Code	Dimensions
041224	180x60x34
041225	180x60x37

Discounts as per spare parts price list



Promotional Material

Displays



Accessory display

Code
022395

Accessory and oil display

Code
022881

Wall-mounted display Wall Unit

Code
023673



Olivator display



Codice
PUBL23

Gadget

Active banner
280 cm



Code
PUBL125

Active flag
180x80 cm



*Without stand

Code
PUBL99

Pen



Code
PUBL42

USB stick 8GB



Code
PUBL107

Plastic pouch



Code
PUBL65

Active water bottle



Code
PUBL135

Notepad



Code
PUBL40

Clothing

Workwear



	Work jacket
Size	Code
M	PUBL19
L	PUBL20
XL	PUBL21
XXL	PUBL22

Vests and sweatshirts



	Gilet	Sweatshirt
Size	Code	Code
S	-	PUBL138
M	PUBL43	PUBL139
L	PUBL44	PUBL140
XL	PUBL45	PUBL141
XXL	PUBL46	PUBL142

T-shirts and polos



	T-shirt	Polo shirt
Size	Code	Code
S	-	PUBL119
M	PUBL27	PUBL118
L	PUBL28	PUBL61
XL	PUBL29	PUBL62
XXL	PUBL30	PUBL63

Hat



Code
PUBL108



ACTIVE[®]

MADE IN ITALY



ACTIVE S.R.L.

Via Delmoncello, 12 - Zona Industriale 26037
San Giovanni in Croce - Cremona - ITALY

Tel. +39 0375 91742 | ordini@active-srl.com | export@active-srl.com

mail@active-srl.com | www.active-srl.com